



OCM

Over 100 Years of Strength

ONE-TOUCH COUPLER

INTERNAL LOCKING TECHNOLOGY

Effortless Installation
SIMPLE, QUICK, EASY

Zero Waste, Maximum Value
**ELIMINATES LABOR
AND MATERIAL WASTE**

Unmatched Innovation
**UNIQUE PATENTED
TECHNOLOGY**

US PATENT NO. US 12,044,010 B2

FORGED BODY • ONE TOUCH REBAR SPLICE COUPLER

*IBC ed 2021, 2018, 2015, 2012 | ACI 318-19 Type 1 & Type 2 | AC133
ICC ESR 4572 | Type 1 ASTM A615 GR60 | ASTM A706 GR60*



**(866) 457-5710 • www.ocm-inc.com
1120 E Peterson Rd, Grayslake, IL 60030**



OCM

Over 100 Years of Strength

ONE TOUCH COUPLER DIMENSIONS:

OCM PART #	COUPLE R ID	REBAR NOMINAL SIZE	WEIGHT	LENGTH		OUTSIDE DIAMETER		REBAR END TO END GAP		REBAR DEPTH INTO COUPLER	
				IN	MM	IN	MM	IN	MM	IN	MM
OTC-R4-D13	D13	#4	0.64	3.937	100	1.102	28	0.157	4	1.890	48.0
OTC-R5-D16	D16	#5	1.23	4.562	116	1.421	36	0.157	4	2.205	56.0
OTC-R6-D19	D19	#6	1.92	5.359	136	1.625	41	0.157	4	2.598	66.0
OTC-R7-D22	D22	#7	2.62	5.309	150	1.859	47	0.157	4	2.874	73.0
OTC-R8-D25	D25	#8	3.75	6.687	170	2.093	53	0.157	4	3.268	83.0
OTC-R9-D29	D29	#9	5.88	7.484	190	2.406	61	0.157	4	3.661	93.0
OTC-R10-D32	D32	#10	8.05	8.265	210	2.671	68	0.157	4	4.055	103.0
OTC-R11-D35	D35	#11	10.6	8.897	226	2.992	76	0.157	4	4.370	111.0
OTC-R14-D43	D43	#14	24.20	11.023	280	3.503	89	0.157	4	5.433	138.0
OTC-R18-D57	D57	#18	52.80	14.370	365	4.921	125	0.157	4	7.106	180.5

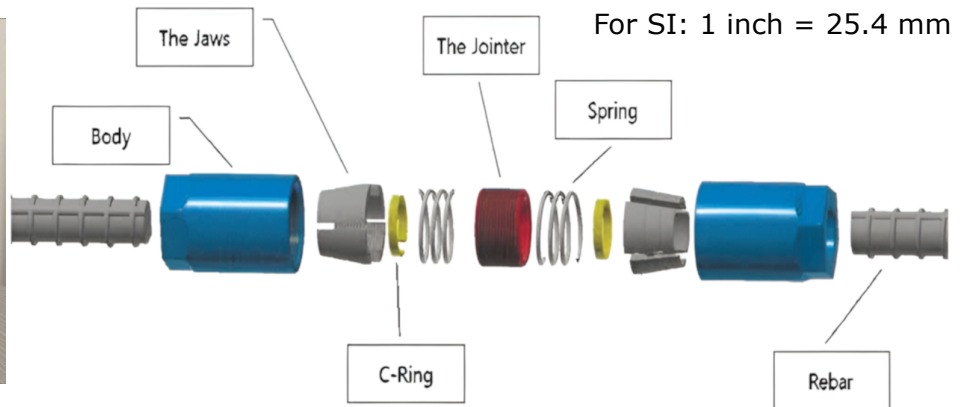

(866) 457-5710 • www.ocm-inc.com
 1120 E Peterson Rd, Grayslake, IL 60030



OCM

Over 100 Years of Strength

INSTALLATION GUIDE



Debur rough edges of the rebar by grinding

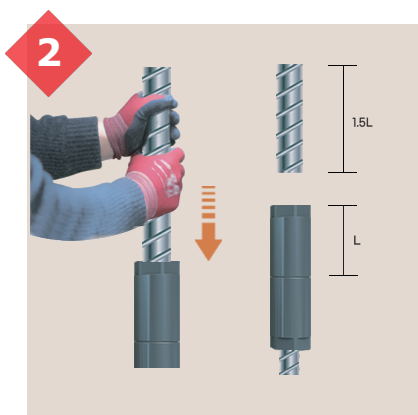

When inserting the rebar into the coupler, grip the rebar at least one full coupler-length away from the coupler opening to avoid jamming injuries

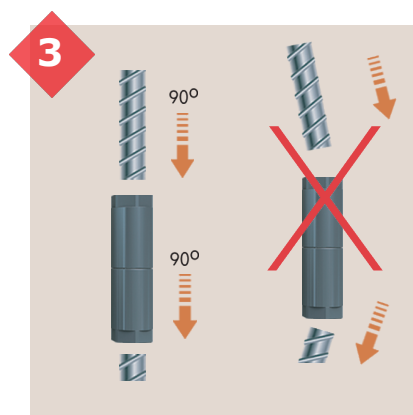

Rebar should be inserted into the coupler in a straight and downward direction to guarantee a perfect connection



(866) 457-5710 • www.ocm-inc.com
1120 E Peterson Rd, Grayslake, IL 60030



OCM

Over 100 Years of Strength



OCM, Inc. Stocking Locations:

Northern California

7888 Marathon Dr. Suite B
Livermore, CA 94550

Chicago

1120 E. Peterson Road.
Grayslake, IL 60030

Philadelphia

250 Hansen Access Road
King of Prussia, PA 19406

Ft. Lauderdale

200 S.W. 12th Avenue
Pompano Beach, FL 33069

Denver

5670 Washington Street
Denver, CO 80216

New Jersey

192 Clifford St.
Newark, NJ 07105

Portland

1525 SE 10th Ave.
Portland, OR 97214

Houston

13323 S. Gessner Rd. Ste. 100
Missouri City, TX 77489

Dallas

11625 Columbia Center
Dallas, TX 75229

Southern California

18320 Mt. Baldy Cir.
Fountain Valley, CA 92708

Minneapolis

8900 109th Ave. N, Ste. 300
Champlin, MN 55316

Kansas City

3225 Harvester Rd.
Kansas City, KS 66115

Canada

1120, 1588 Kebet Way
Port Coquitlam, BC V3C 5M5

Atlanta

605 Wesleyan Drive SW
Atlanta, GA 30336



(866) 457-5710 • www.ocm-inc.com
1120 E Peterson Rd, Grayslake, IL 60030