

Rapid Plate Dowel

Instruction Manual

STEP 1 – Layout

Mark a horizontal line along the mid-depth of the formwork. Use a chalk line or measuring tape to align positions consistently.

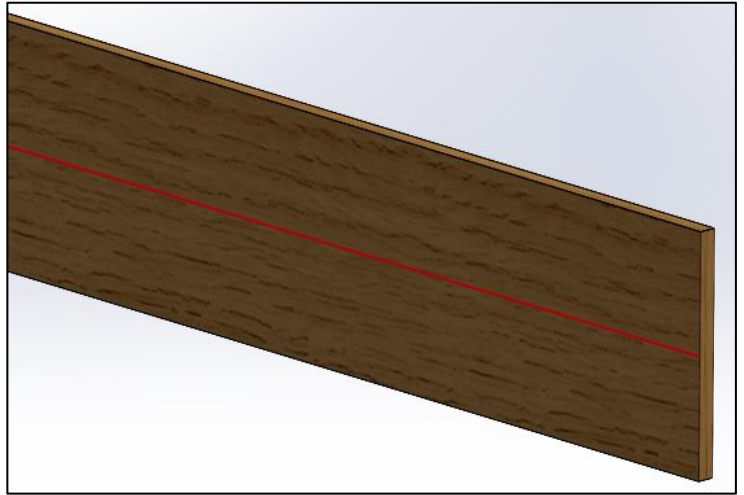

STEP 2 – Level & Align

Ensure each sleeve is level and properly aligned along the chalk line. You can use a spirit level and confirm alignment on the slab. Misalignment may cause dowel binding or joint failure.

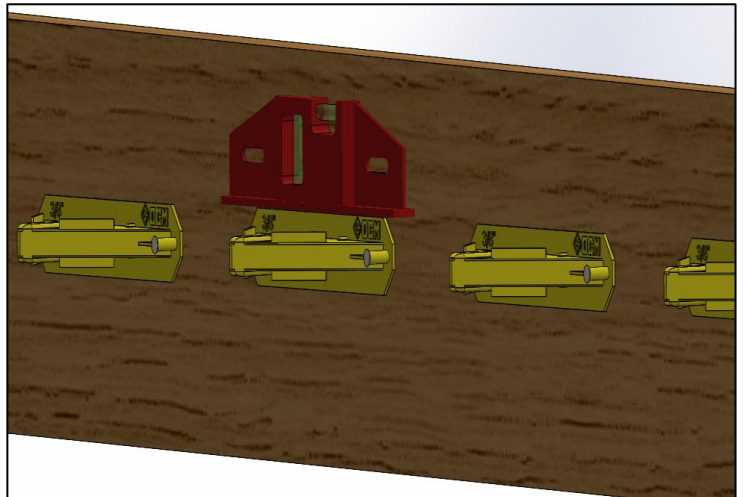

STEP 3 – Attachment

Secure the dowel sleeves to the formwork at the marked locations. The sleeves must be centered on the line and set at the proper slab height — typically mid-depth of the slab. Use the nails provided with the system to secure sleeves.

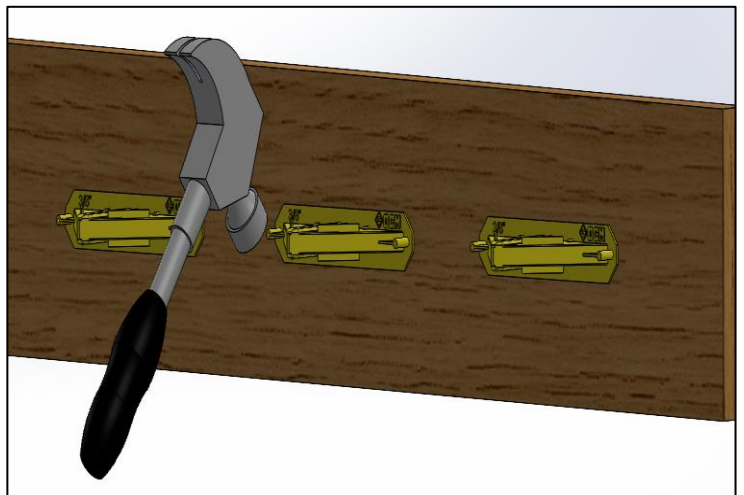



OCM

100 Years of Strength

STEP 4 – First Slab

Pour the first half of the concrete slab. Use internal vibration to properly consolidate the concrete around the sleeves. Do not dislodge the sleeves during pouring. Finish surface per project specs.

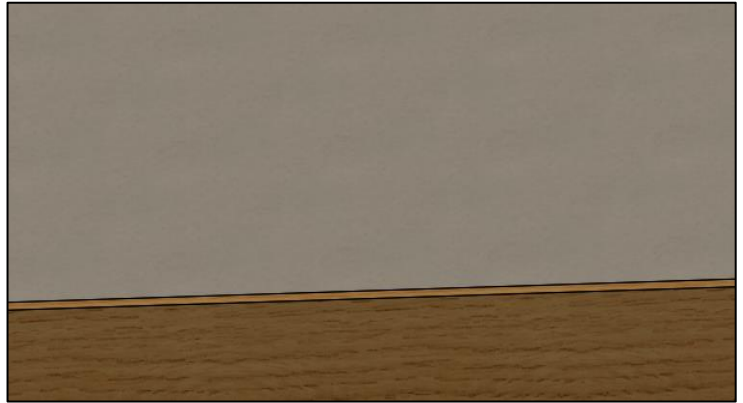

STEP 5 – Removal

After the first slab completely cures, carefully remove the formwork. Take care not to damage the sleeves during removal. Verify that the sleeves remain clean and free from concrete debris.

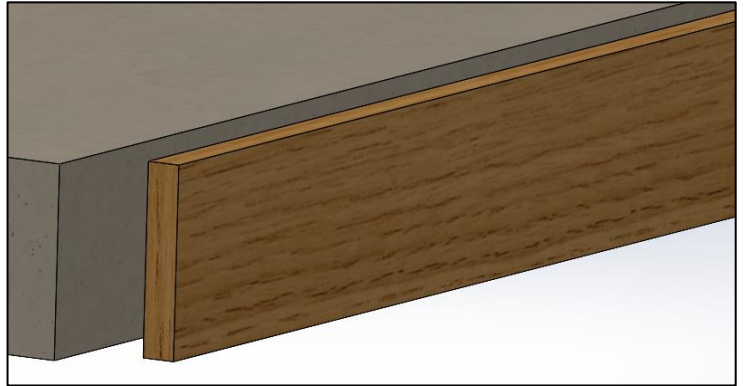

STEP 6 – Plate Insertion

Bend or remove any nails obstructing the sleeve opening. Bend nails away from the sleeve opening. Slide the Rapid Plate Dowel into the sleeve cavity. You will feel an initial resistance when inserting, continue to push through until the dowel is fully inserted.

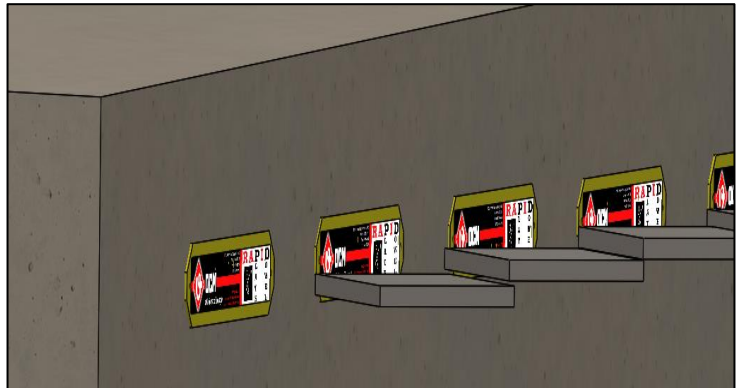

STEP 7 – Second Slab

Pour the second half of the slab. Use internal vibration to consolidate concrete and finish the surface to specifications. After curing, ensure that there is no unintended cracking.

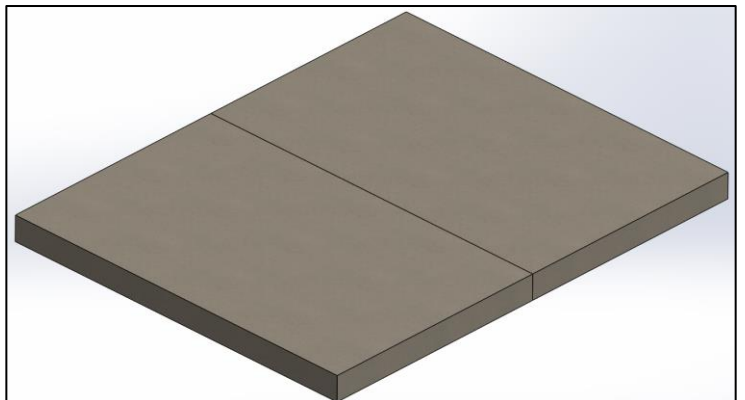

OCM

(866) 457-5710 • www.ocm-inc.com • 250 Hansen Access Rd, King of Prussia, PA 19406