

Lifting Eye

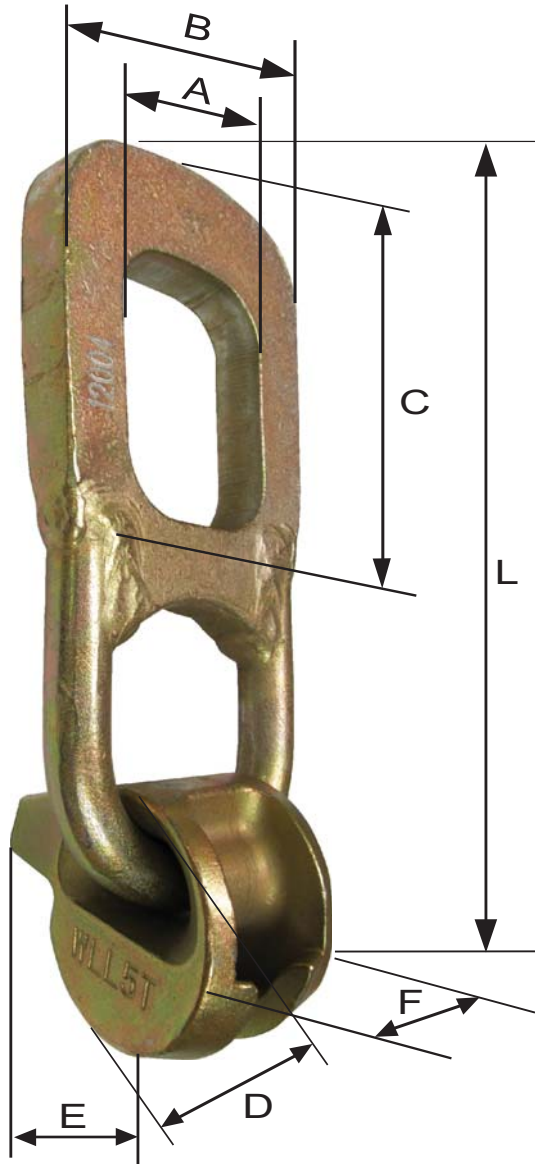

To Order
(Call, Fax or e-mail this form)

1. Part No. : _____
2. Size : _____
3. Quantity : _____

Phone : 1-866-457-5710
 Fax : 1-847-541-9338
 e-mail : sales@ocm-inc.com

OCM Part No.	LIFTING BODY ID	SAFE WORK LOAD	A	B	C	D	E	F	G
#	tons	lb	in.	in.	in.	in.	in.	in.	in.
PLA1TRC	1-1.3 T	2,000	1.87	2.95	2.80	2.20	2.17	1.30	6.48
PLA2TRC	1.5-2.5 T	4,000	2.52	3.86	3.35	2.68	2.76	1.65	8.09
PLA4TRC	3.0-5.0 T	8,000	2.76	4.65	3.45	3.46	3.39	2.24	9.33
PLA8TRC	6.0-10.0 T	16,000	3.74	10.24	4.76	4.41	4.61	2.87	13.72
PLA16TRC	12.0-20.0 T	32,000	4.65	7.32	5.91	5.98	6.10	4.33	17.36
PLA25TRC	25.0-32.0 T	50,000	6.89	10.59	7.44	7.68	8.43	6.02	22.99

SWL provides a safety factor of approximately 5 to 1.