

TYPE#1 90° TY - DOWN HANGER

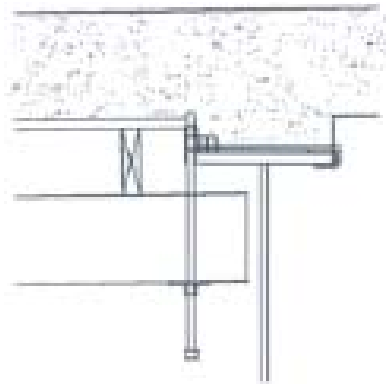

Ty-Down Hanger BH-HFR-HK is manufactured with a 1/2" Dia. 90° end clip. The other end of the strut has a reinforced, 180° wraparound configuration. The wraparound end is fabricated to slip over the flange of a steel bridge beam.

OCM Part No.	Dia	Safe Working Load lbs
BH-HFR-HK	1/2"	3,800

- SWL provides a safety factor of approximately 2 to 1.
- Please specify flange width and finish (PLAIN or HDG) when ordering.